

hortiOne

LED GROW LIGHTS



Knob & Bluetooth



DIMMER

Knob + Bluetooth

(DCG-BLE)

horiONE Dimmer Knob & Bluetooth can simultaneously control up to 3 LED drivers. horiONE 420 / 600 models are plug & play. The supply voltage comes either directly from a driver with 12V AUX. If this is not available, a USB charger with USB-A interface can be used. Thus, the dimmer is compatible with all 0-10V dimmable drivers. Included are 3 cables for horiONE LED. These can optionally be removed and all compatible drivers can be connected (DIY). There are 3 function modes: 1. KNOB, 2. Bluetooth (Directly from smartphone to dimmer) with timing and Sunrise / Sunset function. 3. Bluetooth with gateway (Smart) so the dimmer can be controlled via a cloud and also connected to external sensors.



Connection for 3 LED drivers



Plug & Play for horiONE 420 / 600 compatible with 0-10V dimmable driver



Bluetooth antenna

App Control



USB-Type B

Optional: power supply for driver without 12V AUX



Knob

Modes:

Off - 20% - 40% - 60% - 80% - 100%

Wireless (Bluetooth)

Input	LED driver 12V AUX or powered by USB +5V	
Output	0-10 VDC	
Maximum dimming load	100 mA	
Channel	1	
Number of connections	Can connect up to 3 LED driver	3
Max ambient air temperature	Indoor use only	50 °C
Warranty	2 years	
Dimensions	130x68x34 mm	

Dimensions

01. Dimmer

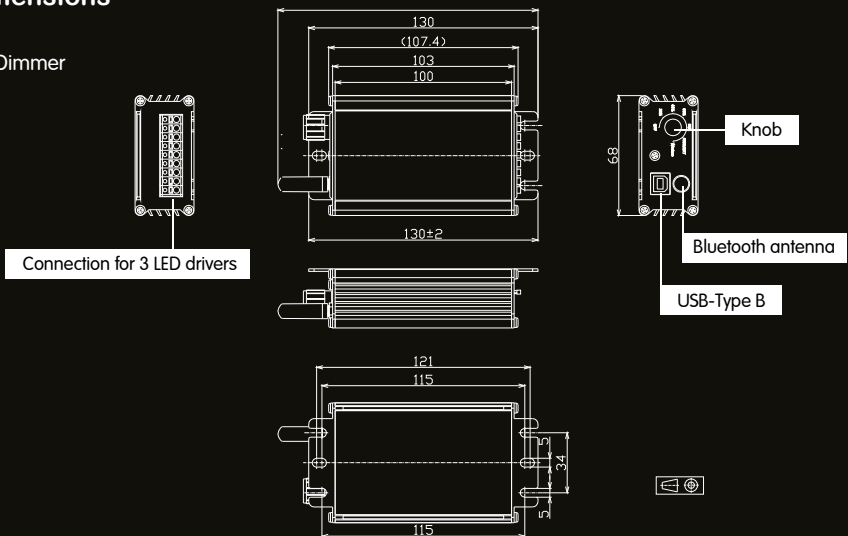

02. Wire



942mm

01. Knob-dimming

When the knob is used for dimming, the bluetooth chip is deactivated and not powered!



Output power is x % of maximum

Modes

- OFF : Dimm off
- 20%
- 40%
- 60%
- 80%
- 100%
- Wireless: Bluetooth mode

02. Bluetooth direct

Power Off / Power On
Stepless dimming from 1-100%
Schedules: (daily light on / off)
Sunrise / sunset function

The connection is solely between the dimmer and the smartphone.
Both units must be inside the signal range.
Distance is depending on the environment



Download tuya smart app
(Android and Apple)

Scan QR-Code on the side or search for "Tuya smart" app



03. Bluetooth smart (requires Gateway!)

Control your grow light via Internet - Connect with external services (Alexa, Google,..)
Connect with external sensor

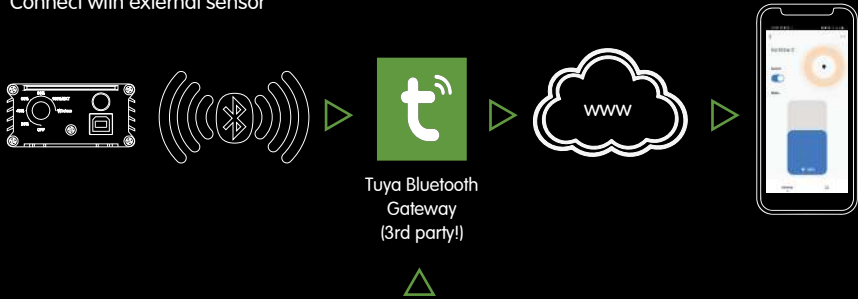

CO2 sensor

Light sensor

Humidity / Temperature sensor

You can monitor sensor values in the same app. These values can also be used to control your LED grow light. Samples: Increase light intensity when the CO2 value is above *** ppm (a defined level)

Note: The required gateway and sensors are 3rd party components and not provided by hortiONE

Connection

hortiONE 420 / 600

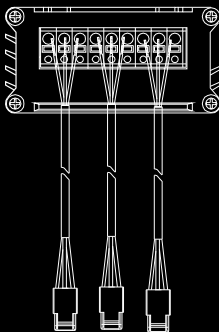

Connect to your hortiONE 420/600 LED GROW LIGHT (plug n play)

3rd Party LED driver (including 12V AUX port) 0/1-10V dimmable LED driver only!

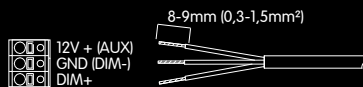

3rd Party LED driver (USB power supply)

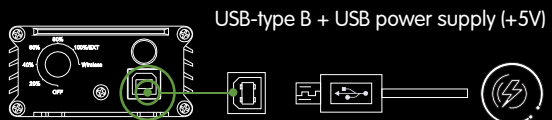

01. Connect the dimmer to your LED driver

The LED driver must be connected to electricity (AC outlet).
hortiONE 420 and hortiONE 600 are plug n play. If you use a hortiONE V1/ V2 or a 3rd party LED driver without 12V AUX connection, a separate USB power supply (Type B) must be used. If more than one LED-driver is connected, only one of them must have a 12V AUX port as power source.

02. Set the knob to wireless

The connected LED grow light will flash one time

03. Open tuya app and add the dimmer

Scan the QR-Code on the first page or search for "Tuya Smart" in your app store.
Start tuya app. Bluetooth must be activated!

Press the (+) and add device
or use the orange button:
Add device

The Dimmer should be found automatically
1. Click Add device
2. Click on the (+)

Click on "Finalize"

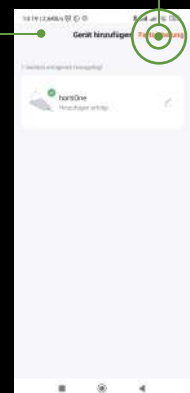
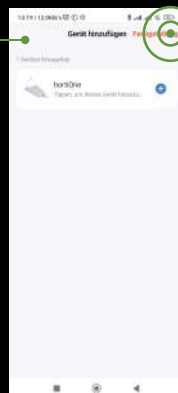

Using the app

Power On
Power Off

Stepless Diming 1 - 100%

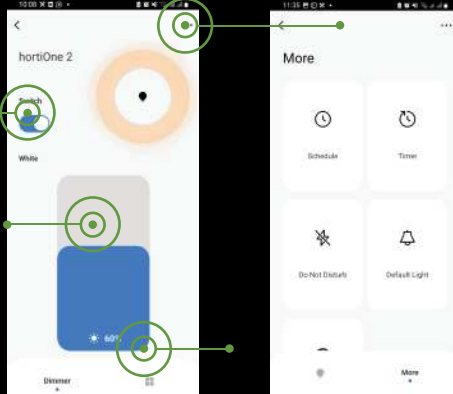

See next Section:
Timer
Sunrise / Sunset

Setting up a timer - Sunrise / Sunset

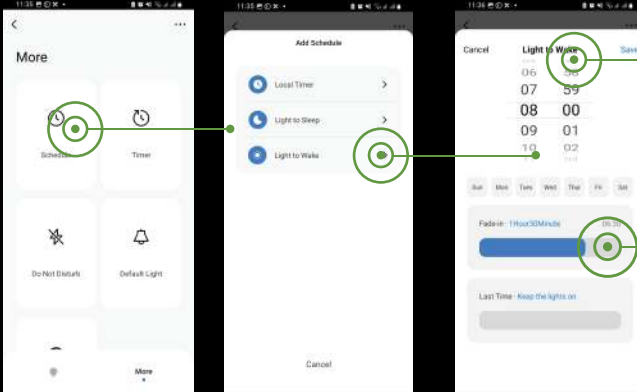

Set start time!

Set fade-In (Sunrise)
Up to 2 hours

Repeat this with Time to sleep
to setup the Illumination period
and sunrise period

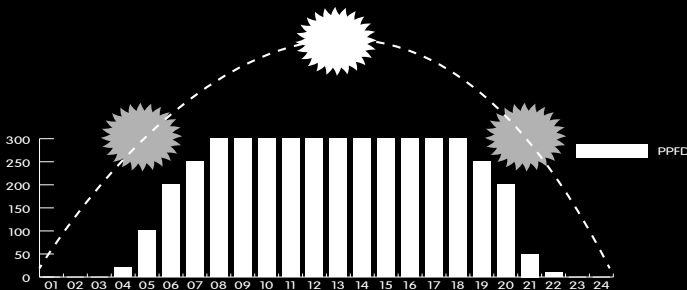



Wireless Dimmer
MODEL DCG-BLE

hortiOne

LED GROW LIGHTS

hortiOne

CE RoHS

Maximum dimming load: 1000mA
Powering by USB - 5V or 12V (500mA Max)
Powered by: USB - 5V or 12V (500mA Max)